

## Unifamiliare Villa a Soldano

**Cod. 4208**

Soldano

**315.000 €**

### Description

Just 1 km from the center of Soldano, a small village served by means and shops, and just 6 km from the sea of Vallecrosia and Bordighera, a house is immediately proposed for sale consisting of two overlapping apartments with independent entrances but communicating from an internal staircase, usable by a single family or wanted by two distinct families. On the mezzanine floor there is the first housing unit, consisting of an entrance in the living area from which you can access the large terrace facing south, continuing inside the house, there is the night hallway, a bathroom and a double bedroom; the lower level consists of a large living room, kitchen and bathroom, the sleeping area has two bedrooms and a second bathroom, also on this floor there is a terrace covered with solar curtains and a large courtyard with garden surrounding the property of about 1000 square meters that is totally fenced and equipped with parking spaces. R 4208

### Main features

<b>Property type</b>	Unifamiliare Villa
<b>Building type</b>	Individuale
<b>Surface</b>	179
<b>Premises/Rooms</b>	6
<b>Bedrooms</b>	3
<b>Bathrooms</b>	3
<b>Lift</b>	No
<b>Parking space/Garage</b>	No

### Expenses

<b>Property price</b>	315.000 €
-----------------------	-----------

### Construction

<b>Property status</b>	Buono
<b>Exposure</b>	ENOS
<b>Heating</b>	autonomo ( 0 )
<b>Energy class</b>	G
<b>Rateable value</b>	196 €

### Distance from

<b>Sea</b>	0 m
<b>City centre</b>	1 km
<b>Railway station</b>	9 km
<b>Shops</b>	1 km
<b>Highway toll booth</b>	0 m
<b>Bus stop</b>	600 m



PIANTA PIANO SEMINTERRATO



PIANTA PIANO SEMINTERRATO



PIANTA PIANO TERRA

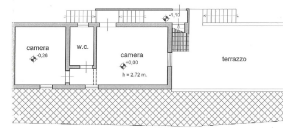

PIANTA PIANO TERRA

